

## QuickReel®

3A9347A

EN

***For replacement of handle with a hose reel kit on 695 XT, 795 XT, 1095 XT, Mark IV/V/VII XT sprayers. For repair of XT ProContractor sprayers. For professional use only.***

**Models: 25V145, 25V146**

*3300 psi (228 bar, 22.8 MPa) Maximum Working Pressure*



### **Important Safety Instructions**

Read all warnings and instructions in this manual and in the applicable sprayer manual before using the equipment. Save these instructions.

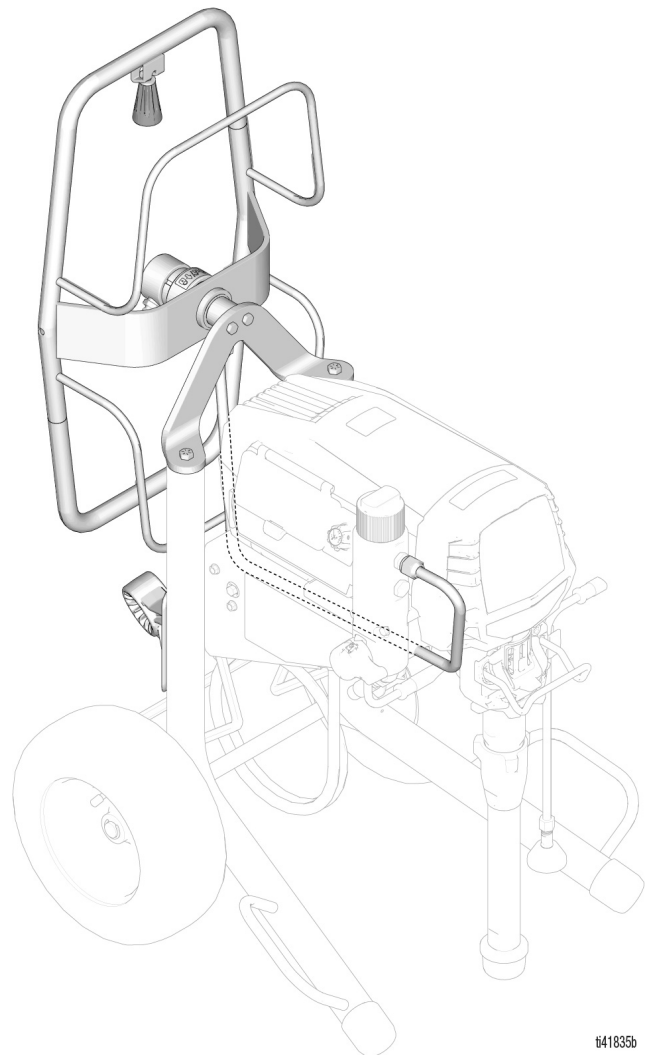

t641835b



# Contents

<b>Warnings</b> .....	<b>3</b>	<b>Parts</b> .....	<b>10</b>
<b>Pressure Relief Procedure</b> .....	<b>5</b>	Parts List .....	10
Trigger Lock .....	6	<b>Technical Specifications</b> .....	<b>11</b>
<b>Handle Removal</b> .....	<b>7</b>	<b>California Proposition 65</b> .....	<b>11</b>
<b>QuickReel Installation Instructions</b> .....	<b>8</b>	<b>Graco Standard Warranty</b> .....	<b>12</b>
<b>QuickReel Removal Instructions</b> .....	<b>9</b>		

Related Manuals	Description
3B0070	Sprayer Manual

# Warnings

The following warnings are for the setup, use, grounding, maintenance, and repair of this equipment. The exclamation point symbol alerts you to a general warning and the hazard symbols refer to procedure-specific risks. When these symbols appear in the body of this manual or on warning labels, refer back to these Warnings. Product-specific hazard symbols and warnings not covered in this section may appear throughout the body of this manual where applicable.

 <b>WARNING</b>	
	<p><b>SKIN INJECTION HAZARD</b></p> <p>High-pressure fluid from gun, hose leaks, or ruptured components will pierce skin. This may look like just a cut, but it is a serious injury that can result in amputation. <b>Get immediate surgical treatment.</b></p> <ul style="list-style-type: none"> <li>• Do not spray without tip guard and trigger guard installed.</li> <li>• Engage trigger lock when not spraying.</li> <li>• Do not point gun at anyone or at any part of the body.</li> <li>• Do not put your hand over the spray tip.</li> <li>• Do not stop or deflect leaks with your hand, body, glove, or rag.</li> <li>• Follow the <b>Pressure Relief Procedure</b> when you stop spraying and before cleaning, checking, or servicing equipment.</li> <li>• Tighten all fluid connections before operating the equipment.</li> <li>• Check hoses and couplings daily. Replace worn or damaged parts immediately.</li> </ul>
	<p><b>ENTANGLEMENT HAZARD</b></p> <p>Rotating parts can cause serious injury.</p> <ul style="list-style-type: none"> <li>• Keep clear of moving parts.</li> <li>• Do not wear loose clothing, jewelry or long hair while operating equipment.</li> </ul>

# **WARNING**



## **EQUIPMENT MISUSE HAZARD**

Misuse can cause death or serious injury.



- Do not operate the unit when fatigued or under the influence of drugs or alcohol.
- Do not exceed the maximum working pressure or temperature rating of the lowest rated system component. See **Technical Specifications** in all equipment manuals.
- Use fluids and solvents that are compatible with equipment wetted parts. See **Technical Specifications** in all equipment manuals. Read fluid and solvent manufacturer's warnings. For complete information about your material, request Safety Data Sheets (SDSs) from distributor or retailer.
- Do not leave the work area while equipment is energized or under pressure.
- Turn off all equipment and follow the **Pressure Relief Procedure** when equipment is not in use.
- Check equipment daily. Repair or replace worn or damaged parts immediately with genuine manufacturer's replacement parts only.
- Do not alter or modify equipment. Alterations or modifications may void agency approvals and create safety hazards.
- Make sure all equipment is rated and approved for the environment in which you are using it.
- Use equipment only for its intended purpose. Call your distributor for information.
- Route hoses and cables away from traffic areas, sharp edges, moving parts, and hot surfaces.
- Do not kink or over bend hoses or use hoses to pull equipment.
- Keep children and animals away from work area.
- Comply with all applicable safety regulations.



## **TOXIC FLUID OR FUMES HAZARD**

Toxic fluids or fumes can cause serious injury or death if splashed in the eyes or on skin, inhaled, or swallowed.

- Read Safety Data Sheets (SDSs) to know the specific hazards of the fluids you are using.
- Store hazardous fluid in approved containers, and dispose of it according to applicable guidelines.



## **PERSONAL PROTECTIVE EQUIPMENT**

Wear appropriate protective equipment when in the work area to help prevent serious injury, including eye injury, hearing loss, inhalation of toxic fumes, and burns. Protective equipment includes but is not limited to:

- Protective eyewear, and hearing protection.
- Respirators, protective clothing, and gloves as recommended by the fluid and solvent manufacturer.

# Pressure Relief Procedure

This equipment stays pressurized until pressure is manually relieved. To help prevent serious injury from pressurized fluid, such as skin injection, splashing fluid and moving parts, follow the **Pressure Relief Procedure** when you stop spraying and before cleaning, checking, or servicing equipment.

1. Engage the trigger lock.



2. Turn ON/OFF switch to the **OFF** position and unplug the power cord.

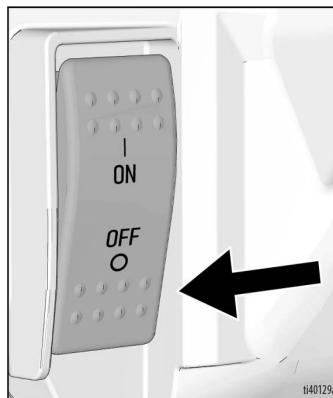

3. Turn pressure control to the lowest setting.

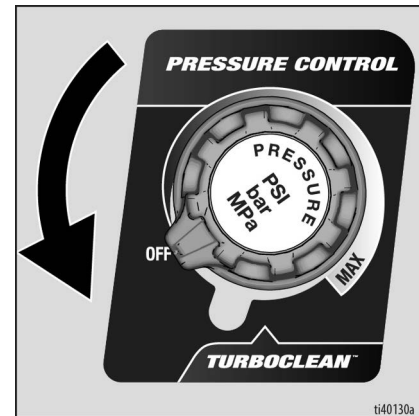

4. Put drain tube in a pail and turn prime valve down to relieve pressure. Leave prime valve in the down (drain) position until you are ready to spray again.

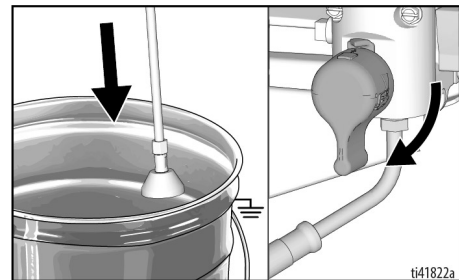

5. Hold a metal part of the spray gun firmly to a grounded metal pail. Point spray gun into pail. Disengage the trigger lock and trigger the spray gun to relieve pressure.

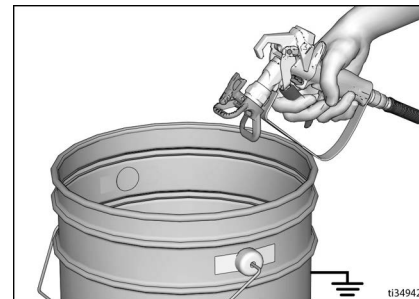

6. Engage the Trigger Lock.
7. If you suspect the spray tip or hose is clogged or that pressure has not been fully relieved:
  - a. Using a wrench, **VERY SLOWLY** loosen the tip guard retaining nut or the hose end coupling to relieve pressure gradually.
  - b. Loosen the nut or coupling completely.
  - c. Clear hose or tip obstruction.

## Trigger Lock

Always engage the trigger lock when sprayer is stopped to prevent the gun from being triggered accidentally by hand or if dropped or bumped.

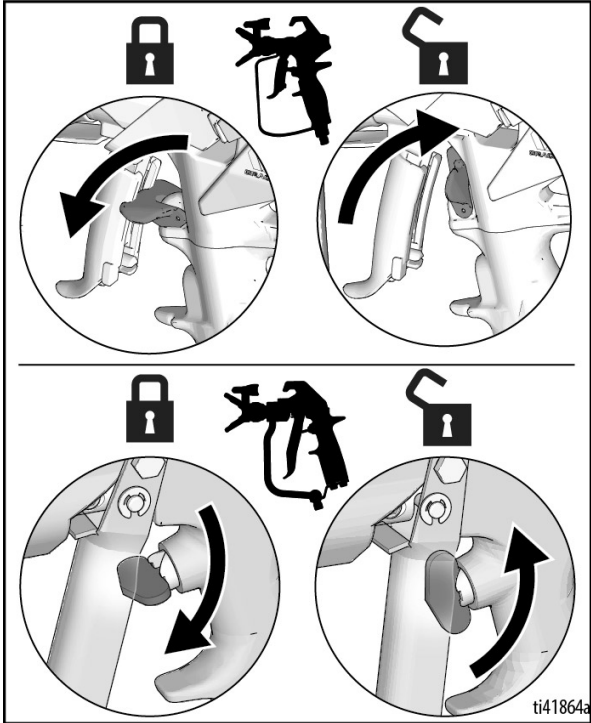

# Handle Removal

1. Perform **Pressure Relief Procedure**, page 5.
2. Loosen and remove screws (x4) and handle.

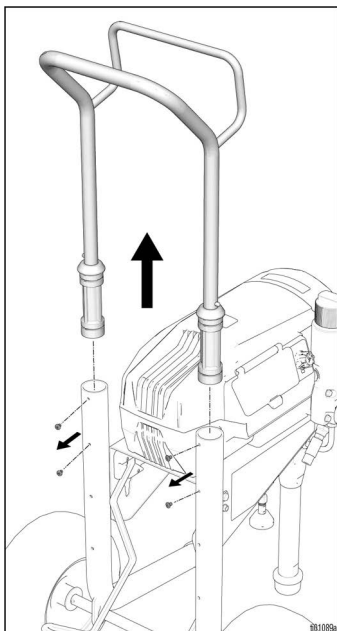

3. Remove plug and fitting.

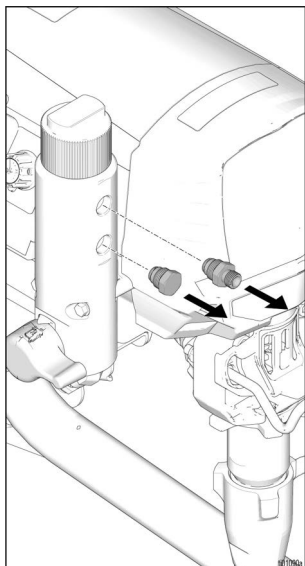

4. Replace fitting with plug removed in step 3. Torque to 40-50 ft./lbs.

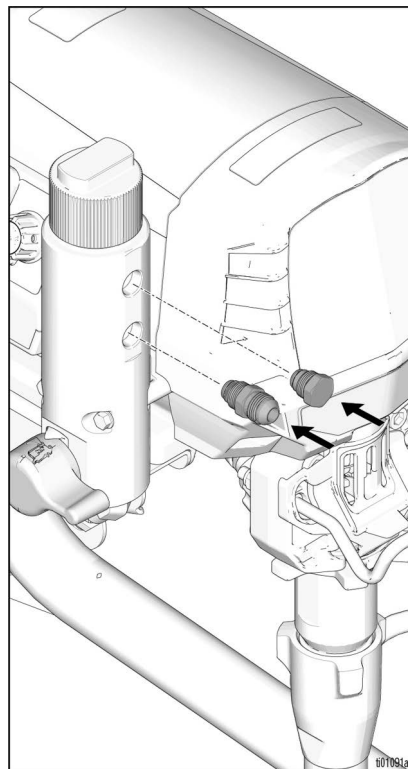

5. Replace plug from step 3 with fitting included with hose reel kit. Torque to 40-50 ft./lbs.

## NOTICE

When installing plug and fitting, use a socket/ratchet or box-end wrench. Avoid using adjustable or open-end wrenches as it is easier to accidentally strip the plug and fitting with these tools.

**NOTE:** When removing and replacing plugs and fittings, ensure installed O-rings are not lost.

## NOTICE

When removing plug and fitting, use a socket/ratchet or box-end wrench. Avoid using adjustable or open-end wrenches as it is easier to accidentally strip the plug and fitting with these tools.

# QuickReel Installation Instructions

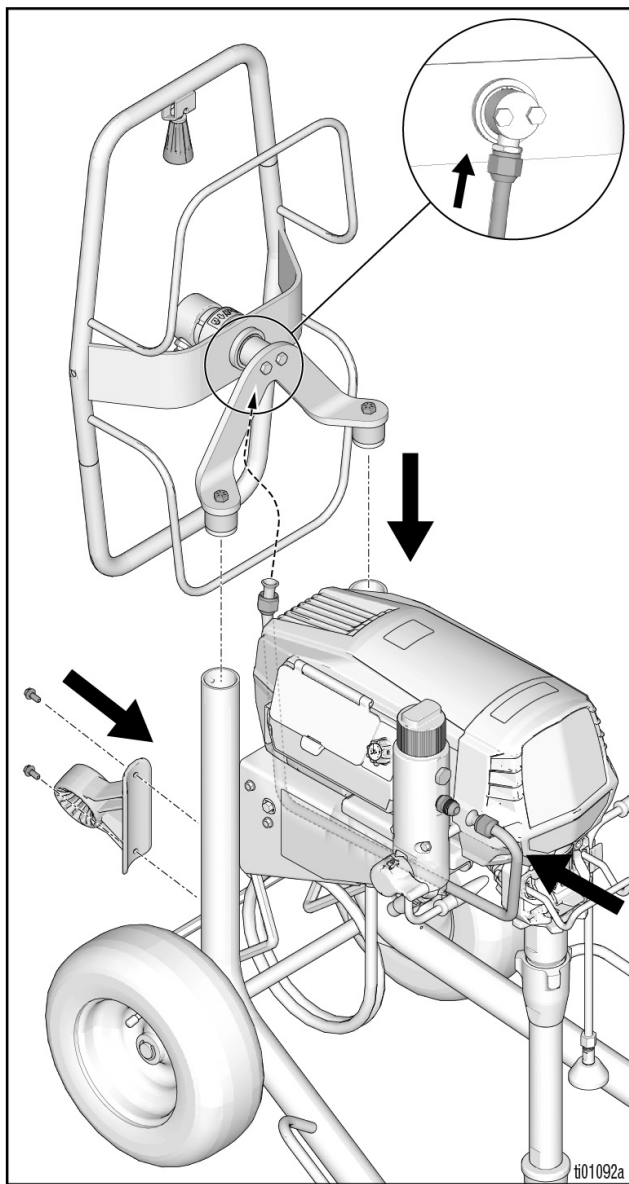

1. Perform **Pressure Relief Procedure**, page 5.

2. Attach hose guide to frame. Torque screws holding hose guide (x2) to 40-45 in-lb.

**NOTE:** When assembling, hose guide should lean outward from the leg (towards the tire) and not inward.

3. Drop hose reel in place. Tap bracket straight down until it is bottomed out on the frame.

4. Finish assembling hose to fitting by tightening the connection.

5. Torque fasteners (x2) in top of hose reel bracket to 40-50 ft-lb.

6. Route rigid tube through the unit, outside the power cord and above the pump and drain lines.

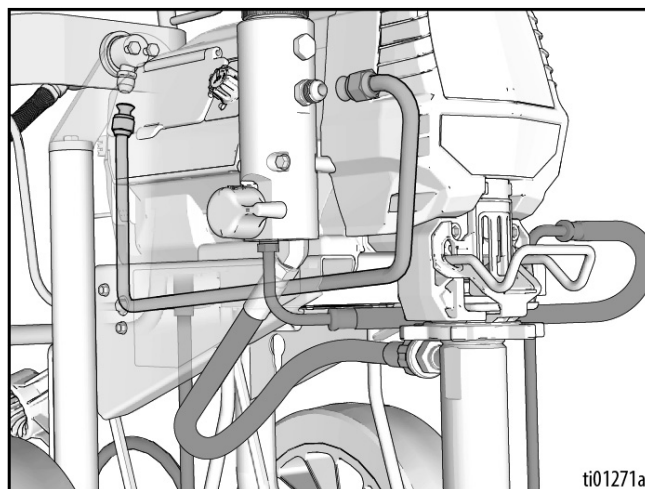

7. Attach formed tube to back fitting on hose reel and tighten.

8. Stretch and seat formed tube on the connection at the front. Hand tighten, then fully tighten.



9. Thread hose through hose guide. Apply pipe thread sealant to fitting. Assemble swivel fitting to hose reel fitting. Ensure collar is in the unlock position. Wind hose onto reel by rotating hose reel clockwise.

**NOTE:** The hose reel fitting is either a 1/4 in., 3/8 in. or 1/2 in. depe

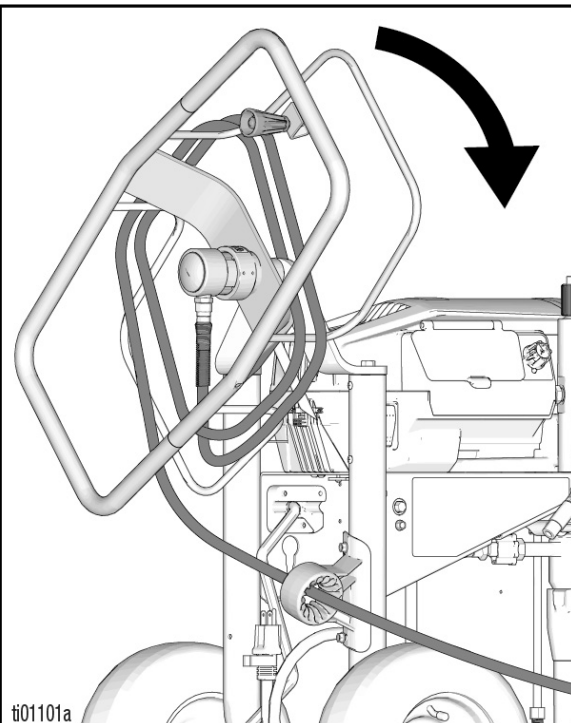
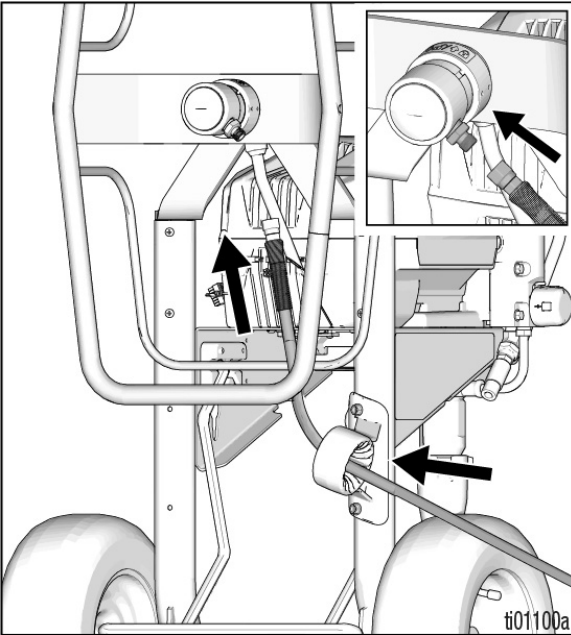

## QuickReel Removal Instructions

1. Perform **Pressure Relief Procedure**, page 5.
2. Loosen fasteners (x2) two full turns (same fasteners from step #6 in the installation instructions).
3. Tap fastener heads with hammer until head contacts bracket.
4. Lift hose reel off frame.

Parts

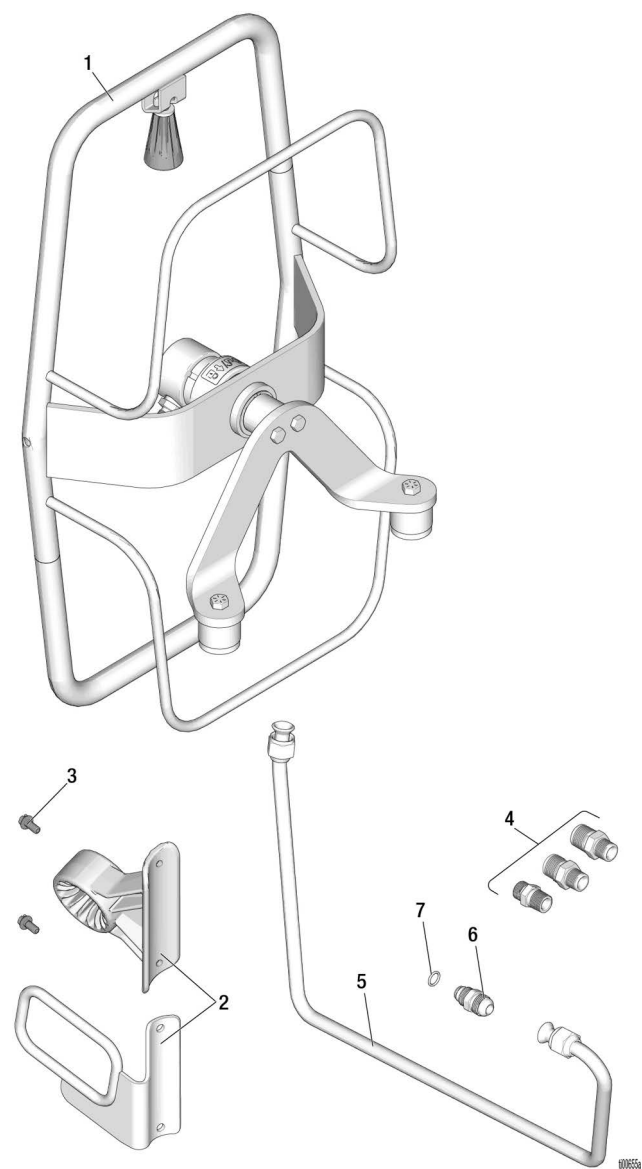

Parts List

Ref.	Part	Description	Qty	Ref.	Part	Description	Qty
1		REEL, hose, XT, includes 2, 3, 4, 5, 6, 7	1	4		FITTING, connector, NPT*	1
	25V145	1/4 in. and 3/8 in. NPT			164672	1/4 in. Model 25V145	
	25V146	1/2 in. NPT			162485	3/8 in. Model 25V145	
2		GUIDE, hose, XT	1		159239	1/2 in. Model 25V146	
	19D922	Model 25V145		5	2002230	TUBE, formed	1
	2002139	Model 25V146		6	20B491	ADAPTER, nipple	1
3	117633	SCREW, slot hex wash hd.	2	7	107505	O-RING, packing	1

\* Model 25V145 contains with both 1/4 and 3/8 fittings.

## Technical Specifications

	US	Metric
Sprayer		
Maximum fluid working pressure	3300 psi	228 bar
Materials of Construction		
Wetted materials	Zinc- and nickel-plated carbon steel, nylon, stainless steel, PTFE, Acetal, leather, UHMWPE, aluminum, tungsten carbide, PEEK, brass, polyethylene	
Notes		
All trademarks or registered trademarks are the property of their respective owners.		

## California Proposition 65

### CALIFORNIA RESIDENTS

 **WARNING:** Cancer and reproductive harm – [www.P65warnings.ca.gov](http://www.P65warnings.ca.gov).

# Graco Standard Warranty

Graco warrants all equipment referenced in this document which is manufactured by Graco and bearing its name to be free from defects in material and workmanship on the date of sale to the original purchaser for use. With the exception of any special, extended, or limited warranty published by Graco, Graco will, for a period of twelve months from the date of sale, repair or replace any part of the equipment determined by Graco to be defective. This warranty applies only when the equipment is installed, operated and maintained in accordance with Graco's written recommendations.

This warranty does not cover, and Graco shall not be liable for general wear and tear, or any malfunction, damage or wear caused by faulty installation, misapplication, abrasion, corrosion, inadequate or improper maintenance, negligence, accident, tampering, or substitution of non-Graco component parts. Nor shall Graco be liable for malfunction, damage or wear caused by the incompatibility of Graco equipment with structures, accessories, equipment or materials not supplied by Graco, or the improper design, manufacture, installation, operation or maintenance of structures, accessories, equipment or materials not supplied by Graco.

This warranty is conditioned upon the prepaid return of the equipment claimed to be defective to an authorized Graco distributor for verification of the claimed defect. If the claimed defect is verified, Graco will repair or replace free of charge any defective parts. The equipment will be returned to the original purchaser transportation prepaid. If inspection of the equipment does not disclose any defect in material or workmanship, repairs will be made at a reasonable charge, which charges may include the costs of parts, labor, and transportation.

**THIS WARRANTY IS EXCLUSIVE, AND IS IN LIEU OF ANY OTHER WARRANTIES, EXPRESS OR IMPLIED, INCLUDING BUT NOT LIMITED TO WARRANTY OF MERCHANTABILITY OR WARRANTY OF FITNESS FOR A PARTICULAR PURPOSE.**

Graco's sole obligation and buyer's sole remedy for any breach of warranty shall be as set forth above. The buyer agrees that no other remedy (including, but not limited to, incidental or consequential damages for lost profits, lost sales, injury to person or property, or any other incidental or consequential loss) shall be available. Any action for breach of warranty must be brought within two (2) years of the date of sale.

**GRACO MAKES NO WARRANTY, AND DISCLAIMS ALL IMPLIED WARRANTIES OF MERCHANTABILITY AND FITNESS FOR A PARTICULAR PURPOSE, IN CONNECTION WITH ACCESSORIES, EQUIPMENT, MATERIALS OR COMPONENTS SOLD BUT NOT MANUFACTURED BY GRACO.** These items sold, but not manufactured by Graco (such as electric motors, switches, hose, etc.), are subject to the warranty, if any, of their manufacturer. Graco will provide purchaser with reasonable assistance in making any claim for breach of these warranties.

In no event will Graco be liable for indirect, incidental, special or consequential damages resulting from Graco supplying equipment hereunder, or the furnishing, performance, or use of any products or other goods sold hereto, whether due to a breach of contract, breach of warranty, the negligence of Graco, or otherwise.

## **FOR GRACO CANADA CUSTOMERS**

The Parties acknowledge that they have required that the present document, as well as all documents, notices and legal proceedings entered into, given or instituted pursuant hereto or relating directly or indirectly hereto, be drawn up in English. Les parties reconnaissent avoir convenu que la rédaction du présente document sera en Anglais, ainsi que tous documents, avis et procédures judiciaires exécutés, donnés ou intentés, à la suite de ou en rapport, directement ou indirectement, avec les procédures concernées.

# Graco Information

For the latest information about Graco products, visit [www.graco.com](http://www.graco.com).

For patent information, see [www.graco.com/patents](http://www.graco.com/patents).

**TO PLACE AN ORDER**, contact your Graco distributor or call 1-800-690-2894 to identify the nearest distributor

*All written and visual data contained in this document reflects the latest product information available at the time of publication.  
Graco reserves the right to make changes at any time without notice.*

Original instructions. This manual contains English. MM

**Graco Headquarters:** Minneapolis

**International Offices:** Belgium, China, Japan, Korea

**GRACO INC. AND SUBSIDIARIES • P.O. BOX 1441 • MINNEAPOLIS MN 55440-1441 • USA**  
**Copyright 2023, Graco Inc. All Graco manufacturing locations are registered to ISO 9001.**

[www.graco.com](http://www.graco.com)  
Revision , December 2023